

SPL 2420 Surface Mount Power Inductor



APPLICATIONS

- ◇ DC/DC converters.
- ◇ Computers.
- ◇ Telecommunications Equipment.
- ◇ Filters.
- ◇ LCD Display.

CHARACTERISTICS

Flat Top for surface mounting.
High Current SMD, up to 2.4 ADC.

FLAMABILITY: To UL94V0.

TEMPERATURE RANGE: -40°C to 85°C.

SOLDERABILITY: Excellent for IR soldering.

PACKAGING: Tape and Reel only.

NOTES:

- (1) Inductance tested at 100Khz, 0.10VRMS.
- (2) Rated Current based on 10% drop in initial inductance.
- (3) DCR measured on milliohm meter.

Inductance tested at 100 kHz, 0.1 Vrms.

Inductance drop = 10% typ. at Isat.

T = 40°C rise typ at Irms.

Operating temperature range -40°C to +85°C

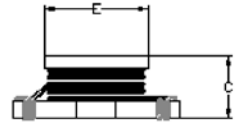
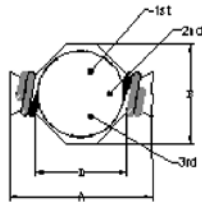

INDUCTANCE VS. FREQUENCY CHARACTERISTICS

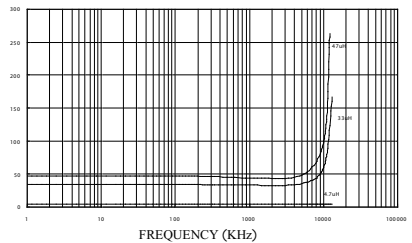

INDUCTANCE VS. IDC CHARACTERISTICS

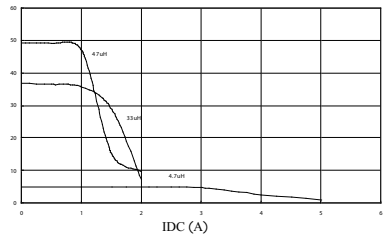

DIMENSIONS IN MM

| UNIT | A Max | B Max | C Max | D | E |
|------|-------|-------|-------|-------|-------|
| in | 0.350 | 0.240 | 0.197 | 0.230 | 0.180 |
| mm | 8.89 | 6.10 | 5.00 | 5.84 | 4.57 |

| Part Number | Ind. (µH) | Tol. (±%) | DCR (Ω) Max | SRF (MHz) Typ | Isat (A) | Irms (A) |
|--------------|-----------|-----------|-------------|---------------|----------|----------|
| SPL2420-R56M | 0.56 | 20 | 0.010 | 200 | 7.7 | 6.0 |
| SPL2420-1R2M | 1.2 | 20 | 0.017 | 140 | 5.3 | 4.4 |
| SPL2420-2R2M | 2.2 | 20 | 0.035 | 100 | 3.5 | 3.1 |
| SPL2420-4R7M | 4.7 | 20 | 0.054 | 50 | 2.6 | 2.2 |
| SPL2420-100M | 10 | 20 | 0.111 | 40 | 1.9 | 1.5 |
| SPL2420-150M | 15 | 20 | 0.17 | 30 | 1.5 | 1.2 |
| SPL2420-220M | 22 | 20 | 0.25 | 25 | 1.2 | 1.0 |
| SPL2420-330M | 33 | 20 | 0.37 | 20 | 0.99 | 0.82 |
| SPL2420-470M | 47 | 20 | 0.47 | 15 | 0.87 | 0.7 |