

# LC57 Series Unshielded Inductors

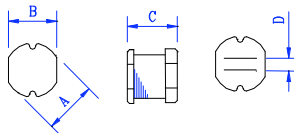
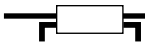

Dimensions in mm

TYPE	A	B	C	D
LC57	5.8 ± 0.3	5.2 ± 0.3	4.5 ± 0.4	1.3

Part Number	Inductance (uhy)	Test Freq.	DCR Ohms max.	Rated Current DC amps max.
LC57-100M	10	2.52Mhz	.10	1.44
LC57-120M	12	2.52Mhz	.12	1.40
LC57-150M	15	2.52Mhz	.14	1.30
LC57-180M	18	2.52Mhz	.15	1.23
LC57-220M	22	2.52Mhz	.18	1.11
LC57-270M	27	2.52Mhz	.20	.97
LC57-330M	33	2.52Mhz	.23	.88
LC57-390M	39	2.52Mhz	.32	.80
LC57-470M	47	2.52Mhz	.37	.72
LC57-560K	56	2.52Mhz	.42	.68
LC57-680K	68	2.52Mhz	.46	.61
LC57-820K	82	2.52Mhz	.60	.58
LC57-101K	100	1.0Khz	.70	.52
LC57-121K	120	1.0Khz	.93	.48
LC57-151K	150	1.0Khz	1.10	.40
LC57-181K	180	1.0Khz	1.38	.38
LC57-221K	220	1.0Khz	1.57	.35
LC57-271K	270	1.0Khz	1.85	.29
LC57-331K	330	1.0Khz	2.00	.28
LC57-391K	390	1.0Khz	2.60	.26
LC57-471K	470	1.0Khz	3.00	.12
LC57-561K	560	1.0Khz	4.19	.10
LC57-681K	680	1.0Khz	4.44	.08
LC57-821K	820	1.0Khz	5.12	.05
LC57-102K	1000	1.0Khz	10.00	.03

Notes.

1. Current rating based on 25% decrease from initial inductance at 0ADC.
2. Operating temp range: -20 Deg. C to + 80 Deg. C.
3. Temp rise to be 40 Deg C max. at rated current.
4. 10% inductance tolerance. Replace "M" with "K" in part number.
5. Manufactured to RoHS compliance.