

LC105 Series Unshielded Inductors

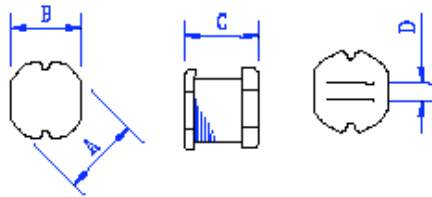
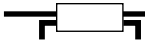

TYPE	A	B	C	D
LC105	10.0 ± 0.3	9.0 ± 0.3	4.0 ± 0.5	2.1

LC105 Series Inductors

Part Number	Inductance (uhy)	Test Freq.	DCR Ohms max.	Rated Current DC amps max.
LC105-100M	10	2.5Mhz	0.05	2.38
LC105-120M	12	2.5Mhz	0.06	2.13
LC105-150M	15	2.5Mhz	0.07	1.87
LC105-180M	18	2.5Mhz	0.08	1.73
LC105-220M	22	2.5Mhz	0.09	1.60
LC105-270M	27	2.5Mhz	0.10	1.44
LC105-330M	33	2.5Mhz	0.12	1.26
LC105-390M	39	2.5Mhz	0.15	1.20
LC105-470M	47	2.5Mhz	0.17	1.10
LC105-560M	56	2.5Mhz	0.20	1.01
LC105-680M	68	2.5Mhz	0.22	0.91
LC105-820M	82	2.5Mhz	0.25	0.85
LC105-101M	100	1Khz	0.34	0.74
LC105-121M	120	1Khz	0.40	0.69
LC105-151M	150	1Khz	0.54	0.61
LC105-181M	180	1Khz	0.62	0.56
LC105-221M	220	1Khz	0.72	0.53
LC105-271M	270	1Khz	0.95	0.45
LC105-331M	330	1Khz	1.10	0.42
LC105-391M	390	1Khz	1.24	0.38
LC105-471M	470	1Khz	1.53	0.35
LC105-561M	560	1Khz	1.90	0.32

Notes:

1. Test Freq: 1.0 ~ 8.2μH(7.96MHz/1V), 10 ~ 82μH (2.52MHz/1V), 100 ~ 1000μH (1kHz/1V).
2. Test Instrument: L: HP 4192A; DCR: CHEN HWA 502BC; Rated D.C. Current: HP4284+42841A or CH1061+CH301A
3. Packaging: T : Tape and Reel – RoHS Compliant.
4. Tolerance : M= ±20%