

# SSL5028 Shielded Power Inductor



## CHARACTERISTICS

Flat top for surface mounting.  
High Current SMD, up to 5.5 ADC.

**FLAMABILITY** To UL94V0.

**TEMPERATURE RANGE** -40°C to 85°C.

**SOLDERABILITY** Excellent for IR soldering.

## SHIELDED

**PACKAGING** Tape and Reel only.

## NOTES:

- (1) Inductance measured at 100kHz, 0.10Vrms.
- (2) Temperature range -40°C to 85°C.

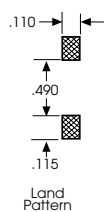
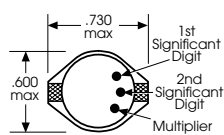
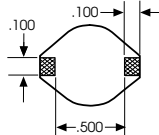
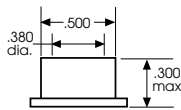

## APPLICATIONS

- ◇ DC/DC converters
- ◇ Computers
- ◇ Telecommunications Equipment
- ◇ Filters
- ◇ LCD Display

Inductance tested at 0.1 Vrms, 100kHz.

Inductance drop 10% typ. at Isat.

40°C rise typ. at Irms.

Operating temperature range: 40°C to +85°C

**TEST INSTRUMENTS:** HP4291A Impedance / Material Analyzer

INDUCTANCE vs. FREQUENCY CHARACTERISTICS

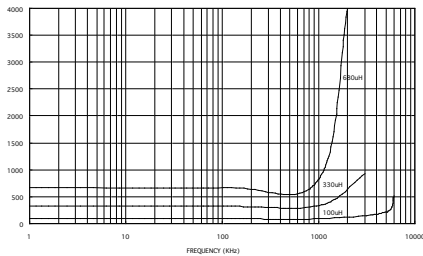

INDUCTANCE vs. IDC CHARACTERISTICS

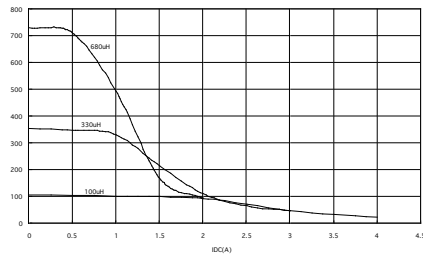

Part Number	Inductance (µH)	Tolerance (±%)	Q Min.	Q Frq (MHz)	DCR (Ω) Max	Isat (A)	Irms (A)
SSL5028-100M	10	40	100	0.040	24	5.5	3.9
SSL5028-150M	15	40	100	0.048	16	4.5	3.4
SSL5028-220M	22	30	100	0.059	14	3.5	3.1
SSL5028-330M	33	40	100	0.075	11	3.3	2.8
SSL5028-470M	47	40	100	0.097	8.0	2.7	2.4
SSL5028-680M	68	40	100	0.140	7.0	2.2	2.0
SSL5028-101M	100	40	100	0.210	5.5	1.7	1.7
SSL5028-151M	150	50	100	0.300	4.8	1.3	1.3
SSL5028-221M	220	50	100	0.470	4.0	1.1	1.1
SSL5028-331M	330	50	100	0.780	3.0	0.86	0.86
SSL5028-471M	470	50	100	1.08	2.4	0.73	0.73
SSL5028-681M	680	60	100	1.40	2.0	0.64	0.64
SSL5028-102M	1000	60	100	2.01	1.0	0.53	0.53