

LC34S SMD Shielded Inductor Series

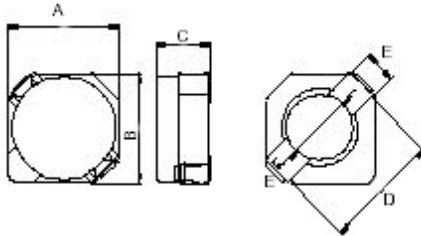

	A	B	C	D	E	F
LC34S SERIES	3.2 Max	3.2 Max	2.0 Max	3.3	2.1	1.0

Part Number	Inductance (uhy)	DCR Ohms max.	Rated Current DC amps max.
LC34S-2R2T	2.2	0.041	0.85
LC34S-3R3T	3.3	0.054	0.75
LC34S-4R7T	4.7	0.078	0.63
LC34S-6R8T	6.8	0.106	0.52
LC34S-100T	10	0.180	0.43
LC34S-150T	15	0.220	0.35
LC34S-220T	22	0.320	0.30
LC34S-330T	33	0.460	0.24
LC34S-470T	47	0.660	0.20

Tolerance: "T" = +/- 30%

L tested at 100K, @ 1.0Volt

Rated Current based on 65% decrease in initial inductance at 0 Amps.